

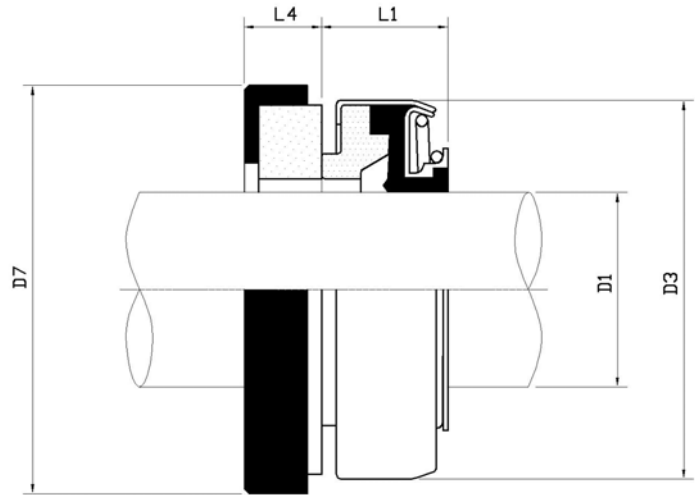

# Sealing Devices

Queensland

## Type S4



### Design Features

Enclosed rubber bellows seal  
European designed  
Main feature is the short working length

### Operating Conditions

**Temperature:** -30°C to +200°C  
(depending on materials used)

**Pressure:** Up to 6 bar, 87 psi

**Speed:** Up to 12m/sec,  
2400fpm

### Materials available

carbon/ceramic/nitrile

sic/sic/viton

### Equivalent to

FA, BO1, T55, CYCLAM seal

| D1   | D3 | D7   | L1   | L2   | L=L1+L2 |
|------|----|------|------|------|---------|
| 6mm  | 18 | 22.0 | 11.0 | 4.0  | 15.0    |
| 8mm  | 18 | 22.0 | 11.0 | 4.0  | 15.0    |
| 8mm  | 18 | 26.0 | 11.0 | 8.0  | 19.0    |
| 10mm | 24 | 26.0 | 11.0 | 8.0  | 19.0    |
| 11mm | 24 | 26.0 | 13.0 | 8.0  | 21.0    |
| 12mm | 24 | 26.0 | 13.0 | 8.0  | 21.0    |
| 12mm | 24 | 25.0 | 13.0 | 5.5  | 18.5    |
| 12mm | 24 | 26.0 | 13.0 | 5.5  | 18.5    |
| 13mm | 24 | 26.0 | 13.0 | 5.5  | 18.5    |
| 13mm | 24 | 26.0 | 13.0 | 8.0  | 21.0    |
| 14mm | 28 | 28.5 | 13.0 | 8.0  | 21.0    |
| 14mm | 28 | 29.5 | 13.0 | 8.0  | 21.0    |
| 14mm | 28 | 25.0 | 13.0 | 6.0  | 19.0    |
| 15mm | 28 | 29.5 | 13.0 | 8.0  | 21.0    |
| 15mm | 32 | 38.0 | 13.0 | 8.0  | 21.0    |
| 16mm | 28 | 29.5 | 13.0 | 8.0  | 21.0    |
| 16mm | 32 | 38.0 | 13.0 | 8.0  | 21.0    |
| 17mm | 39 | 42.0 | 13.0 | 8.0  | 21.0    |
| 18mm | 32 | 32.0 | 13.0 | 6.5  | 19.5    |
| 18mm | 39 | 42.0 | 13.0 | 8.0  | 21.0    |
| 19mm | 39 | 42.0 | 13.0 | 8.0  | 21.0    |
| 20mm | 35 | 35.0 | 15.5 | 8.3  | 23.8    |
| 20mm | 39 | 42.0 | 13.0 | 8.0  | 21.0    |
| 20mm | 42 | 45.0 | 13.0 | 10.0 | 23.0    |
| 22mm | 39 | 42.0 | 13.0 | 8.0  | 21.0    |
| 22mm | 42 | 45.0 | 13.0 | 10.0 | 23.0    |
| 24mm | 47 | 50.0 | 13.5 | 10.0 | 23.5    |
| 25mm | 47 | 50.0 | 13.5 | 10.0 | 23.5    |
| 25mm | 42 | 39.3 | 13.5 | 8.4  | 21.9    |
| 25mm | 42 | 39.3 | 13.5 | 6.0  | 19.5    |
| 28mm | 54 | 57.0 | 15.0 | 10.0 | 25.0    |
| 30mm | 54 | 57.0 | 15.0 | 10.0 | 25.0    |
| 32mm | 54 | 57.0 | 15.0 | 10.0 | 25.0    |
| 35mm | 60 | 63.0 | 16.0 | 10.0 | 26.0    |
| 38mm | 65 | 68.0 | 18.0 | 12.0 | 30.0    |
| 40mm | 65 | 68.0 | 18.0 | 12.0 | 30.0    |
| 45mm | 70 | 73.0 | 20.0 | 12.0 | 32.0    |
| 50mm | 85 | 88.0 | 23.0 | 15.0 | 38.0    |
| 55mm | 85 | 88.0 | 23   | 15   | 38      |